

Assembly, Installation and Operating Instructions for Single anchorage point „Söll Anchorage Eye“

Part no: (for a screw diameter of 16 mm)
Part no: (for a screw diameter of 12 mm)

Serial number: _____

Date of manufacture: _____

(The following must be completed by the operator in permanent waterproof ink.)

Date of initial operation: _____

Operator/user: _____

Street: _____

Place: _____

Tel: _____ Fax: _____



Issue: 30.06.2010

SE 71



Technical modifications reserved!



Contents

A Safety precautions	3
B Assembly/Installation	4
C Application	8
D Care and Maintenance	10
E Checklist	13

Explanation of symbols

	<p>Danger !</p> <p>Improper or careless handling could cause accidents leading to falls or even death.</p>
	<p>Warning !</p> <p>Non-observance could result in serious injury.</p>
	<p>Important !</p> <p>Useful information and user tips are given here.</p>

These instructions are protected by copyright!

They may not be reproduced and distributed in any ways/ by any means without prior written consent of the author according to Articles 16 and 17 of the German Copyright Act. SPERIAN FALL PROTECTION Deutschland GmbH & Co. KG will prosecute any violations against this under Article 106 of the German Copyright Act.

A Safety precautions

- A 1. The user, who uses the single anchorage point for "Söll Anchorage Eye" personal protective equipment, must read and understand this guide before using the system. Action contravening these instructions put people's lives at risk! Operatives must be given training covering these instructions and the user information before starting work and at regular intervals thereafter, but at least once a year.
- A 2. The operator of the single anchorage point must ensure that this guide
- either is kept easily available and well preserved at place of installation
 - or that the system owner keeps the instructions at a location well known and always easily available to a user of the system.
- A 3. The operator must be able to present these instructions at the request of the manufacturer (SPERIAN FALL PROTECTION Deutschland GmbH & Co. KG or one of its authorised dealers).
- A 4. If other personal protective equipment is used against falling or as restraining or rescuing devices and if such equipment is anchored or fixed on the single anchorage point, the corresponding operating instructions of the respective companies and the instructions for use/user information provided by the relevant manufacturer must be followed.
- A 5. Precautions for suitable rescue action must be taken before and during operations in areas presenting a risk of falls.
- A 6. The single anchorage point should only be used for the intended purpose, for e.g. not as a transport anchor or for fastening loads.
- A 7. The site manager of the assembly firm must fill in the checklist (Section E) clearly and correctly using a permanent marker pen.
- A 8. The system has been certified by EC-type test: DEKRA EXAM GmbH, Dinnendahlstraße 9, 44809 Bochum, CE 0158.
- A 9. The user must be in good health and must not be under the influence of alcohol, drugs or medicines when using the single anchorage point.
- A 10. The single anchorage point must only be used in combination with full body harnesses that have been tested and approved in compliance with EN 361.
- A 11. The single anchorage point must only be fixed on buildings or structures that have a typical load bearing capacity of 6 kN (1 user) and 7 kN (2 users).
- A 12. Depending on the application and operating conditions, an expert must check the single anchorage system for its flawless condition, as and when required, however, at least once a year.

B Assembly/Installation

Fig. B 1

B 1. In case of a fall, the impact force on the single anchorage point can be applied in any direction.

Fig. B 1

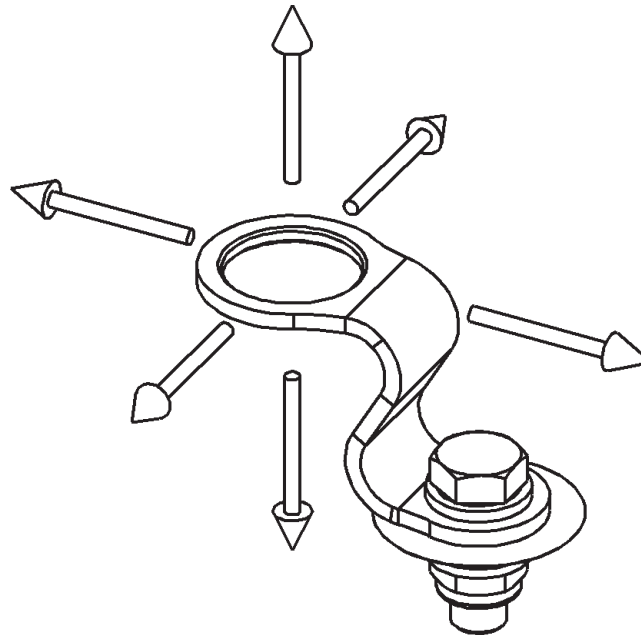

B 2a. **Important !**

 Before installation, check whether the component on which the single anchorage point is to be fixed can withstand the stresses resulting from a fall (certificate for stability). This must be documented in writing by a qualified engineer.

The cross-sections of the components as indicated in the product documentation are minimum values for introduction of the load and are not to be regarded as proof for the above purpose. Otherwise the generally recognised rules of the art apply.

B 2b. Screw diameter, material and tightening torques

The required screw diameter is 12 mm or 16 mm, depending on the "Söll Anchorage Eye" anchorage point model. The use of a 12 mm screw diameter for a 16 mm model is not permitted.

The following tightening torques must be selected: M16 = 100 Nm, M12 = 60 Nm

Stainless steel screws of the A4-70 quality must be used; other qualities require consultation with the manufacturer of the anchorage point.

Fig. B 2

B 3. Installation on reinforced concrete (Fig. B2)

Component requirements:

The minimum quality of concrete and the minimum ceiling thickness **d** depend on the uses for which the fixings are permitted.

Other assembly accessories required:

Exclusively use the dowel pins permitted for reinforced concrete constructions or those technically permissible in Europe for fixing the single anchorage point, with the correct screw diameter in mind (refer to section B 2b).

Assembly:

The fixings must be fitted in accordance with the manufacturer's instructions.

Fig. B 2

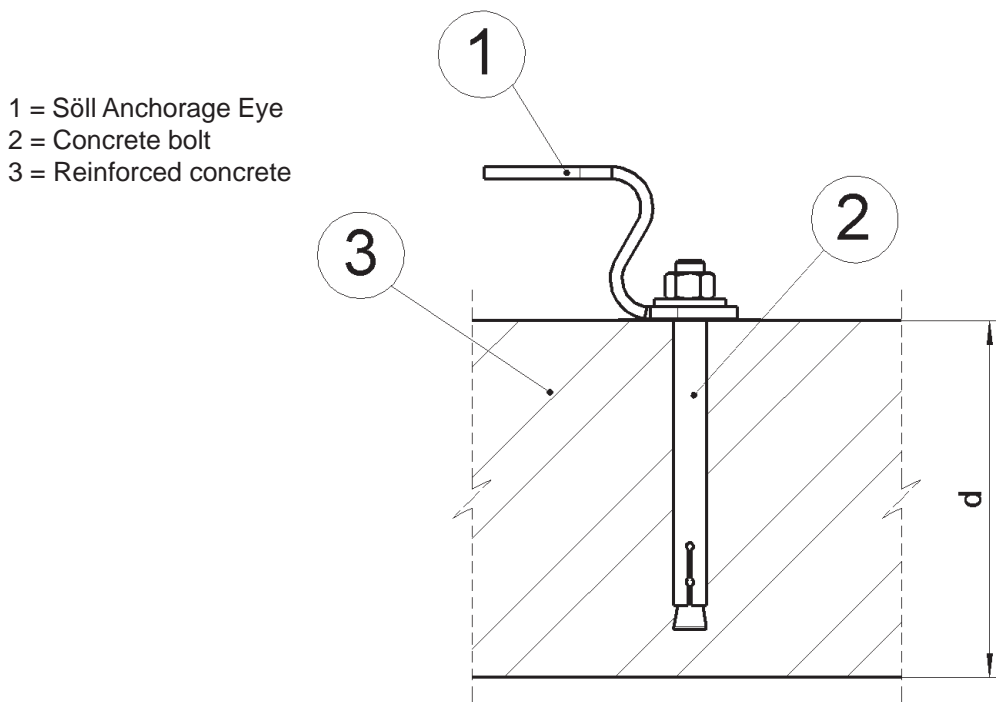

Fig. B 3

B 4. Installation directly on steel girders or on a lightweight concrete ceiling and steel girders

The single anchorage point is directly installed at the flange on a steel beam (refer to the figure below) or on another steel construction (refer to figure B 3.1).

Only suitable stainless steel screws and nuts must be used for fastening. The screw connections must be provided with suitable screw locks. (For e.g. Tuflok, liquid screw lock)

We recommend liquid screw locks for screws (for e.g. Tuflok)

Fig. B 3

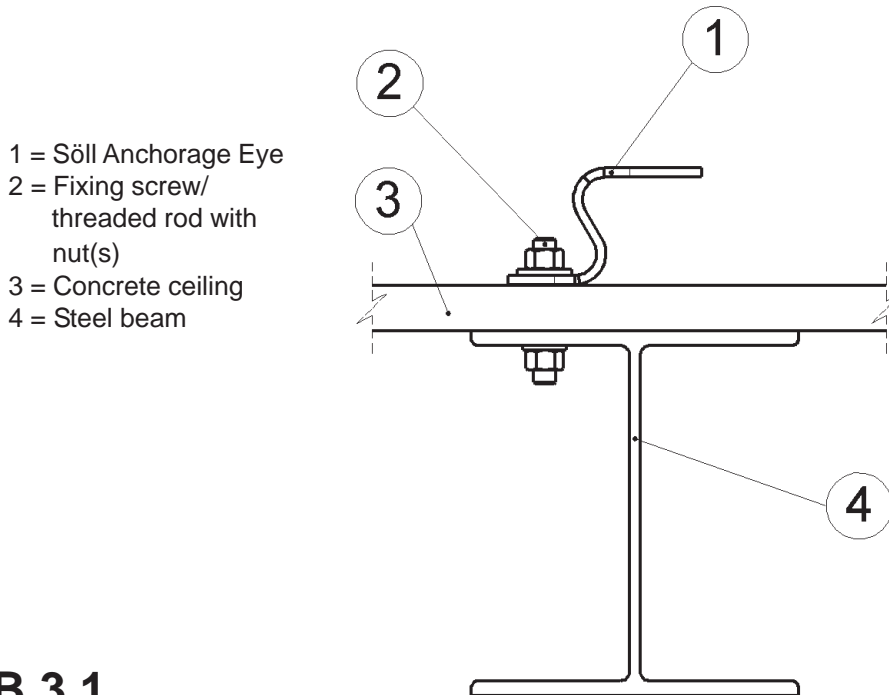

Fig. B 3.1

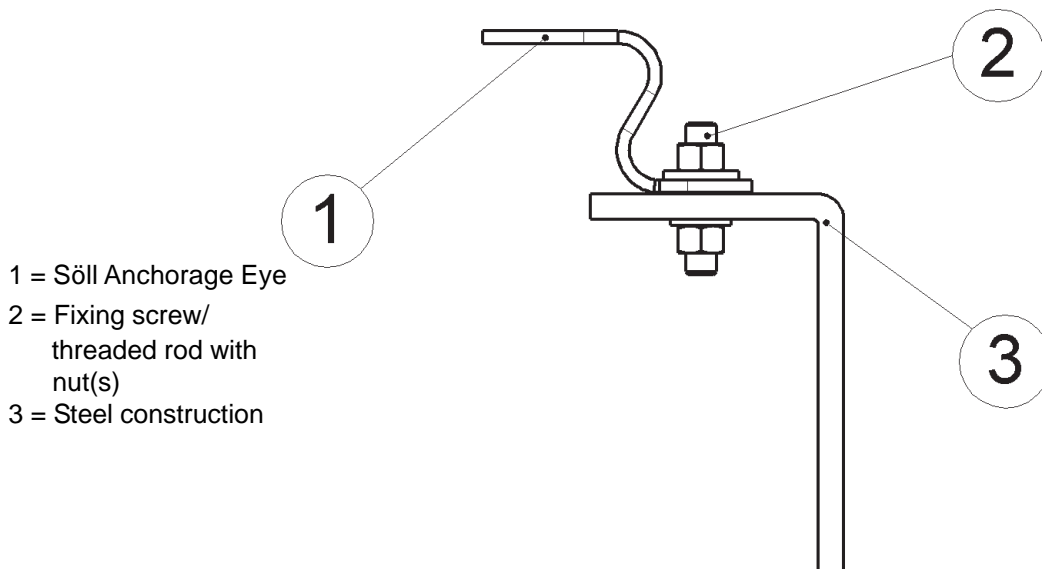

Fig. B 4

B 5. Installation on wooden beams or on a wooden joist ceiling

The single anchorage point is attached to a wooden beam using a mechanical wood connecting element, which must conform to the standards for wooden constructions.

Two types of attachments:

1. Söll Anchorage Eye attached using threaded rods with nuts and washers
2. Söll Anchorage Eye attached using wooden screws.

Fixing method must be approved by building authorities.

Fig. B 4

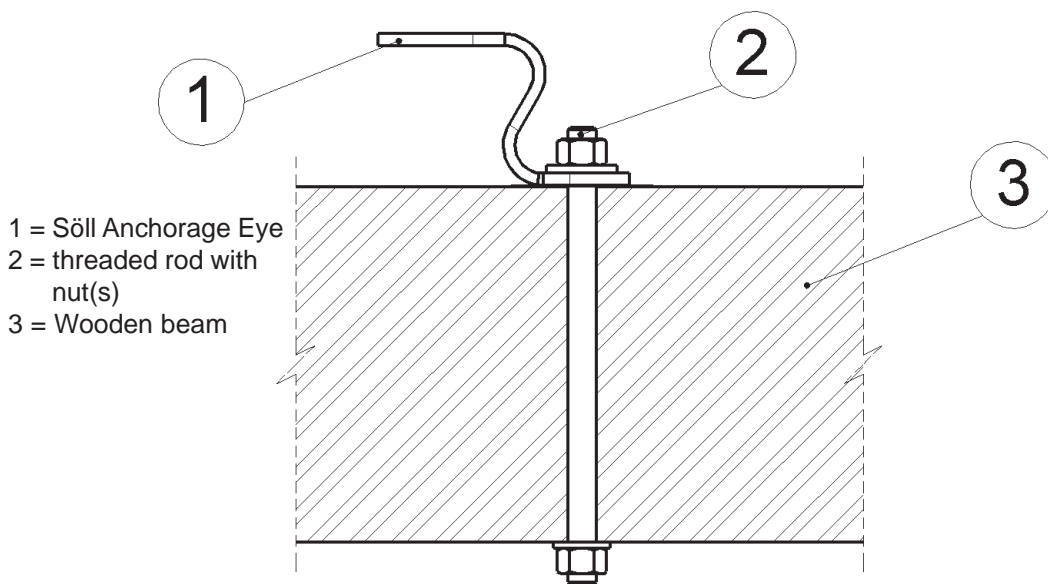
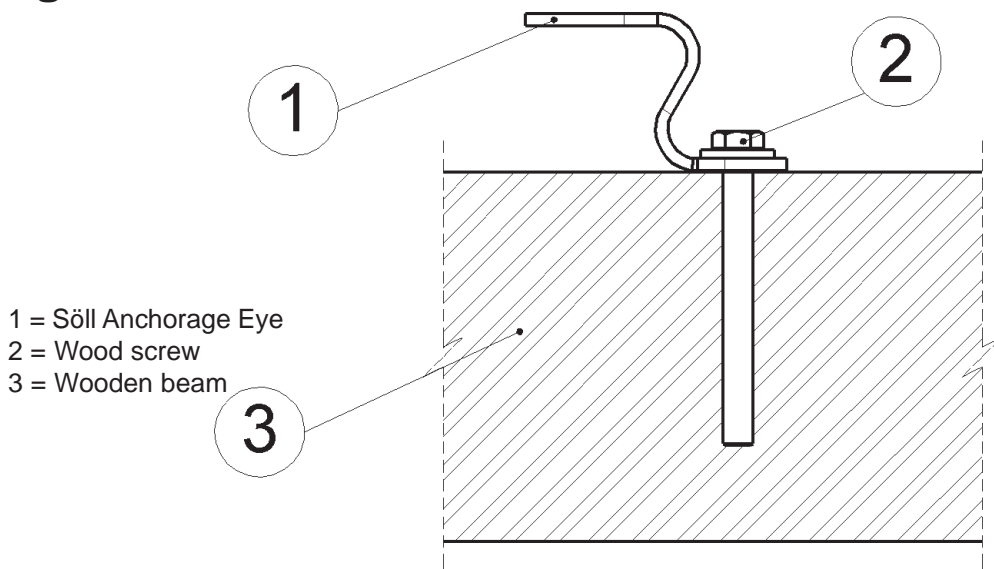

Fig. B 4.1



C Application

- C 1. The "Söll Anchorage Eye" was developed as a single anchorage point for the fall protection of up to 2 people.
- C 2. The characteristic force applied in the single anchorage point must never exceed 22.0 kN.
- C 3. If working in areas presenting a risk of falls, make sure that the operative is in a safe and stable position. Avoid anything in the access or working area that might cause stumbling.
- C 4. A visual inspection for obvious defects and functional capacity must be carried out before and on each use of the device.

C 5. **Warning !**



The single anchorage point must not be used any longer if

- the anchorage point has been subject to stress resulting from a fall,

In this case, an expert must check the single anchorage point and the parts must be replaced by an installer authorised by the manufacturer, if required.

- C 6. The single anchorage point must only be used in combination with the following safety accessories:

- For work presenting a risk of falls, EN 363-compliant fall arrester systems and EN 355-compliant shock absorbers;
- For workplace positioning, EN 358-compliant restraining systems;
- Rescue systems complying with EN 1496, 1497 and 1498.

C 7. **Danger !**



The system of personal protective equipment providing protection against falls (only with shock absorbers), the restraining system or the rescue system that is chosen must be capable of preventing the operative from hitting the ground or colliding with other obstacles. Please refer also to the user information provided by the relevant manufacturer.

Fig. C 1**C 8. Important !**

To protect against falls (**Fig. C1**), attach the snap hook of the lanyard (*Pos.2*) to the colour-coded lifting eye (*Pos.1*) and lock it against inadvertent detaching.

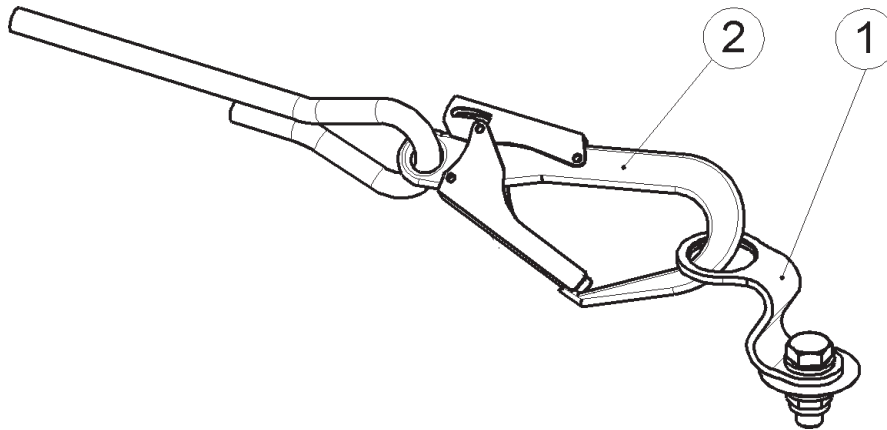
Fig. C 1**C 9. Danger !**

The snap hook of the lanyard (*Pos.2*) must not be detached from the lifting eye (*Pos.1*) until the user is protected against falls by some other means.

D Care and Maintenance

- D 1. For safety reasons do never repair components. Damaged components (e.g. after a fall) shall always be replaced.
- D 2. Only original spare parts or spare parts approved by the manufacturer may be used in repairs.
- D 3. Depending on the application and operating conditions, an expert must check the single anchorage system for its flawless condition, as and when required, however, at least once a year.
- D 4. In order to ensure the load-bearing capacity of the single anchorage point in every direction, the curved eye must be freely rotatable about the screw axis. Otherwise, there could be stress resulting from a fall or an assembly error.

Fig. D 1

D 5. Important!

If a single anchorage point has been deformed over the wear limit, this indicates a previous stress resulting from a fall or faulty use. The wear limit is reached if the dimension "L" is greater than 120 mm and the dimension "H" is not between the 55 – 75 mm range.



Fig. D 1

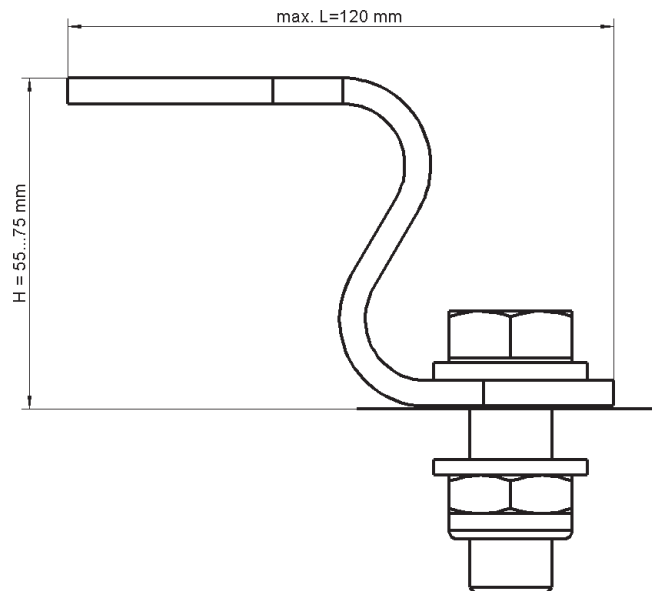

D 6. Warning!



An anchorage device that is deficient or has been subjected to stress from a fall must not be used any longer. It may only be used again if a competent person has approved its further use.

Competent person is a:

person who thanks to his education and experience in the field of personal protective equipment against falls from height has sufficient knowledge about applicable state and local safety regulations, applicable standards (e.g. EN-standards) and is thus capable and thus authorized by Söll of judging the correct status and use of systems and products against falls from height.

Fig. D 2

D 7. The rating plate is in the form of a disc between the anchorage point and the surface below and comprises the following information:

- The manufacturer, supplier or importer of the single anchorage point
- Type code: Söll Anchorage Eye
- Serial number: SN 09 XXXX
- Year of manufacture
- Symbol and identification number of notified body certification by. Tüv Süd Produkt Service GmbH, CE 123
- Standard for anchorage devices: EN 795A/B: 1996
- Pictogram advising the operative to read the directions for use.
- Pictogram advising the operative to wear Fall protection equipment.
- Number of users: 2
- Max. anchor load: 22 kN
- Use the Söll Anchorage Eye only with the personal safety equipment compliant with EN 355 or 360

Fig. D 2



Attention!

There must always be an identification plate.

E Checklist for the acceptance of the single anchorage point tested in compliance with EN 795

„Söll Anchorage Eye“

Part No.:

The check list on pages 13 and 14 must be fully and correctly compiled by the chief engineer of the installing company by means of an indelible pen. He is responsible for the correctness of all the information provided therein. Check points which are characterized by defects or deviate from the description must be described in the list on page 14.

Control Activity

Remarks (please cross)

	yes	no
• All screwed connections are properly tightened	<input type="checkbox"/>	<input type="checkbox"/>
• Only anticorrosive bolt connections have been used.	<input type="checkbox"/>	<input type="checkbox"/>
• No deformation as described in Section D can be seen in the lifting eye.	<input type="checkbox"/>	<input type="checkbox"/>
• The anchorage point is freely rotatable about the screw axis.	<input type="checkbox"/>	<input type="checkbox"/>
• A Söll-system sign is posted.	<input type="checkbox"/>	<input type="checkbox"/>
• There is a structural analysis for the attachment of the single anchorage point.	<input type="checkbox"/>	<input type="checkbox"/>
• Probebegehung wurde durchgeführt.	<input type="checkbox"/>	<input type="checkbox"/>
• This manual was handed over to the operator.	<input type="checkbox"/>	<input type="checkbox"/>
• Only original components from SPERIAN FALL PROTECTION Deutschland GmbH & Co. KG were used.	<input type="checkbox"/>	<input type="checkbox"/>

