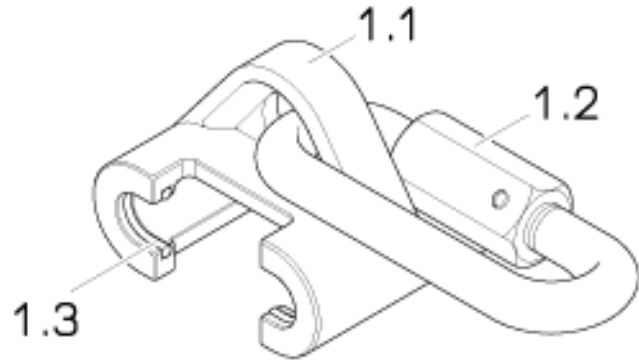

Fig. 4



**E Storage**

As the design of the runner is simple and without any movable parts, it can remain in the system without any problems.

**F Care**

Before inserting the runner or attaching the lanyard in the eyelet it must already be ascertained that the polyamide semi-circles (1.3) are not worn out. Also, if the runner remains in the system, this must be checked.

**Instruction for use and maintenance**  
**Anchorage Device „MultiRail“ horizontal**

closed glider complying with DIN EN 795  
Part-No. 17407

Serial number: \_\_\_\_\_

Date of manufacture: \_\_\_\_\_  
(The following must be completed by the operator in permanent waterproof ink.)

Date of initial operation: \_\_\_\_\_

Operator/user: \_\_\_\_\_

Street: \_\_\_\_\_

Place: \_\_\_\_\_

Tel: \_\_\_\_\_ Fax: \_\_\_\_\_

Date: 03.03.2004

SE26





Maintenance checklist, see Fig. 4

10

	1	2	3	4	5
Year					
Date					
Competent person					
Signature					
<b>Item 1</b>					
<b>Body (1.1)</b>					
Free of dirty					
Marking well legible					
No relevant changes (i.e., due to a fall)					
Has no cracks in the body of the runner					
<b>Item 2</b>					
<b>Suspension eyelet (1.2)</b>					
Not bent					
Has no cracks					
Tensioning pin present					
Tensioning pin undamaged					
<b>Item 3</b>					
<b>Polyamide-semi-circle (1.3)</b>					
All 4 inlays present					
Wear-out limit (metal superficies rubs on the rail) not yet reached					
Not bent, i.e. due to a fall					

## A Safety precautions

- A 1. Before operating the system every person working with or on a Söll „Multi Rail“ end stop device must be made aware of these instructions. Using the system contrary to these instructions will endanger life!
- A 2. The operator of the Söll end stop device must ensure that these instructions are kept safe, dry and readily available **on the installation.**
- A 3. The operator must produce these instructions on demand by the manufacturer of the Söll „Multi Rail“ end stop device (Christian Dalloz HOLDing Deutschland GmbH & Co. KG or one of their authorised dealers).
- A 4. The respective instructions must be observed when assembling, installing or using Söll accessories with this Söll „Multi Rail“ end stop device.
- A 5. The respective instructions must be observed when using other personal protection equipment.
- A 6. The accident prevention regulations BGV A1 and BGV D 36 as well as the „Rules for the use of personal protective equipment against falling and/or for holding and rescuing“ BGR 198 and 199 must also be observed.  
  
When assembling installing this equipment, observe the details listed in UVV BGV C 22 as well as information booklet BGI 530.
- A 7. The runner is part of the Söll „MultiRail“ Anchorage Device and as personal safety equipment has been designed only for correct use with this Söll End Stop system.

- A 8. Söll „Multi Rail“ end stop devices may only be fitted and operated with original Söll components / elements. **Combining with components and/or elements from other manufacturers can adversely affect the safety of the Söll „Multi Rail“ end stop device. In these situations Söll GmbH and their dealers will reject any claims for product liability!**

In addition, such cases are completely unauthorised, as Söll end stop devices are tested and certified as complete systems. Full liability is therefore transferred to the operator!

- A 9. The runner may be used only together with a Söll – Full body harness complying with EN 361. When using other full body harnesses, it must previously be clarified and agreed in written form with Christian Dalloz Holding Deutschland GmbH & Co. KG or with another authorized distributor whether the full body harness concerned is suitable for the use with the runner.
- A 10. Treat the runner with care.
- A 11. Under strain, the deformation of the rail is of approx. 2,0m when the maximum distance of the bracket is of 6,0 and the maximum distance of the rail is of 0,5m. When choosing the length of the lanyard or of the flexible anchor line, it must be considered that collision of the user against the floor or crashing against other obstacles must be avoided. When a guided type fall arrester on flexible anchor line is fixed on the anchorage device, only the devices are to be used, for which the manufacturer grants the functionality also in the planned direction of strain.

## D Maintenance

- D 1. The runner must be checked by a specialist for perfect condition whenever necessary, but at least **once a year**, according to the conditions of use and operational requirements.

### A specialist for personal safety equipment is

someone who has been suitably trained in accordance with ZH 1/55 (basic principles for selection, training and evidence of suitability of specialists for personal fall protection equipment).

- D 2. Check the runner, guide rail, fastening elements as well as safety harness of the system for safe and correct operation in accordance with the relevant instructions.
- D 3. **Maintenance checklist** (see fig.4)

The checklist must be completed by a competent person using permanent waterproof ink and must be signed by that person. The individual items to be checked must be marked with "OK" or "F" (faulty). The competent person shall be responsible for the correct nature of the information. If an "F" has been noted in the remarks, this fault can be corrected and taken away only by the competent person, that is when it concerns removal of dirt (colour, mortar, concrete) on bodies and contact areas and also when it concerns clearing of text or renewal of labels. This procedure shall be noted in the "Remarks" with date and signature of the competent person.

If there is dirt on the inside parts of the fall arrester or if there are defects which involve dismantling, the fall arrester must be sent to the manufacturer (together with the instructions) for inspection, repair and approval.

**For reasons of safety, repairs may only be carried out by the manufacturer.**

With the forefinger, push the safety plate (5.1) on the end plate and move the safety bracket (5.2) downwards with the thumb. Now insert the runner into the rail with the other hand.

The runner (1.0) can now be moved freely on the rail (2.0) by means of the lanyard (3.0).

To remove, unlock the safety bracket (5.2) by means of the safety plate (5.1) and push it downwards. The runner can now be taken out of the rail.

## **B Checking before use**

- B 1. Before any use, the lanyard (z. B. lanyard with shock absorber DIN EN 355) as well as the guide rail (=anchorage device) must be checked visually for perfect condition and operation.
- B 2. The Söll „MultiRail“ Anchorage Device must not be used if a fault is identified or the device was subjected to strain during a fall. It must be taken out of service until such time that a specialist has authorised further use. If necessary, the runner must be retuned to the manufacturer.

### **Attention!**

A specialist is not authorised to carry out repairs!

## **C Using the runner**

Fit the EN 361 safety harness in accordance with the applicable instructions.

### **If using:**

- a safety rope with EN 355 fall arrester, attach this to the back eyelet of the safety harness in accordance with the instructions.

### **Important!**

The fall arrester must always be on the body side!

- a travelling fall arrester with flexible guide, use only equipment that the manufacturer has guaranteed will also function in the planned direction of strain.

**Attention!**

The runner is to be inserted in the guide rail and the user may attach to the runner only when he is in a position secured against falls. Before removing the runner or detaching from the lanyard, (safety line, guided type fall arrester) safety against falls has to be otherwise provided.

C 1. **Mounting/removing the runner****Warning:**

Before removing the runner from the guide rail, you must take other measures to ensure protection against falls.

1. Alternative

**Use:** Fixed end stop (Part-No. 17404)

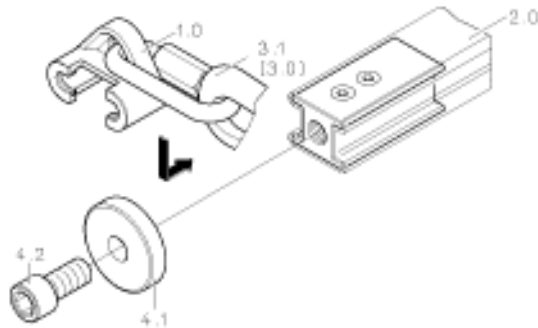
**Fig. 1**

Remove the stop plate (4.1) by detaching the screw (4.2). Insert the runner (1.0) into the guide rail „MultiRail“ (2.0). Hereinafter, fix the stop plate (4.1) again by means of the screw (4.2), to avoid accidental gliding out of the runner. Now, the runner can be moved freely on the guide rail (1.1) by means of the lanyard (2.0). To detach the runner, screw out the stop plate (4.1) and remove the runner from the rail. Finally, fix the stop plate again by means of the screw.

2. Alternative

**Use:** Rail end stop with exit (Part-No. 17861)

**Fig. 2**